

Push chain 0402

3.2 Type 40 PSG

3.2.1 Technical data

- max. push force (for 1 meter of chain unguided, load guided):8000 N
- weight per meter:..... 5,8 kg
- number of links per meter: 25

3.2.2 Dimensions

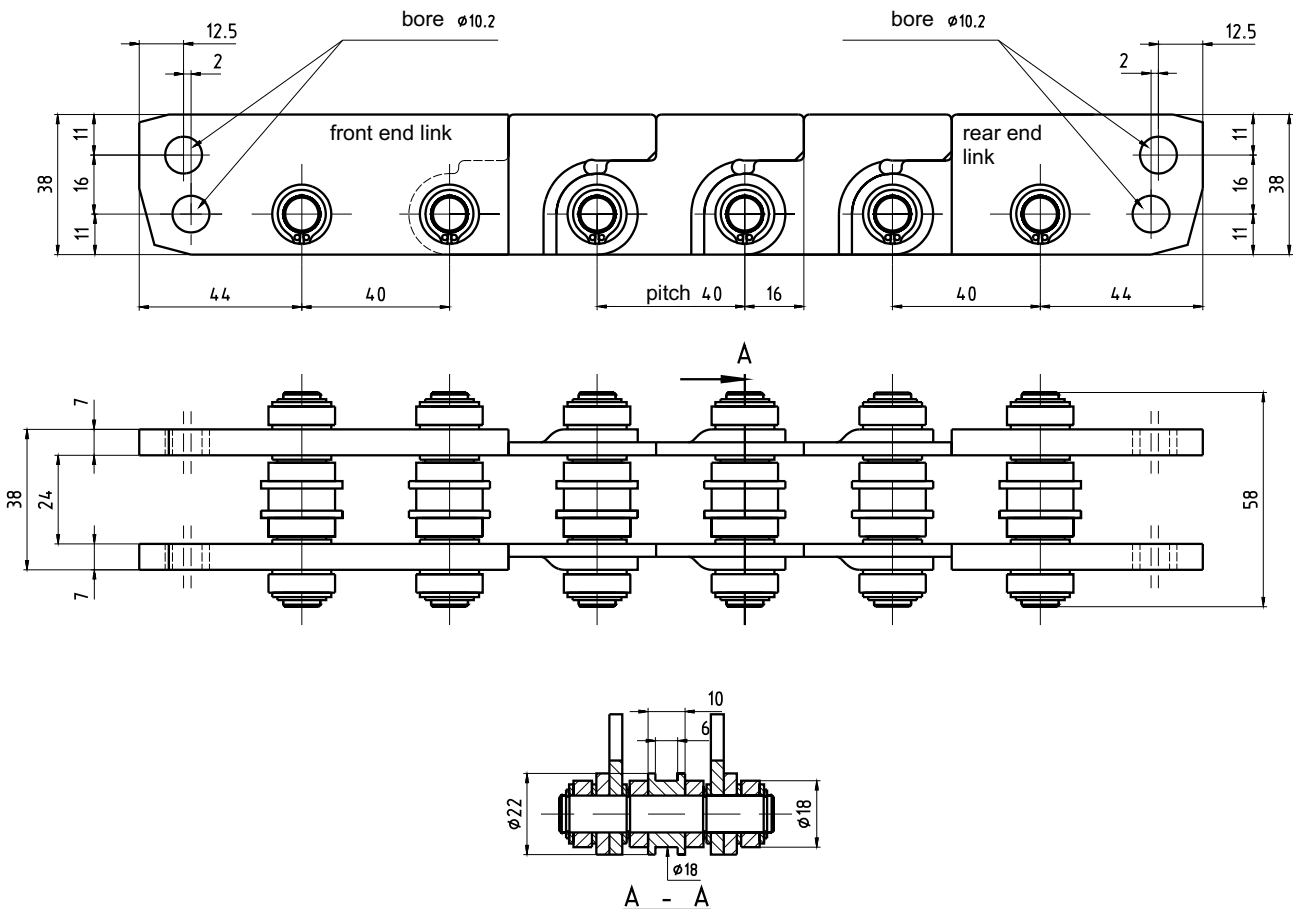

3.2.3 Guiding rail 40 PSG

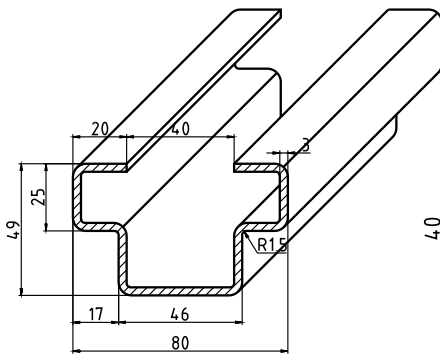

Standard profil guide
weight: ca. 4,8 kg/m

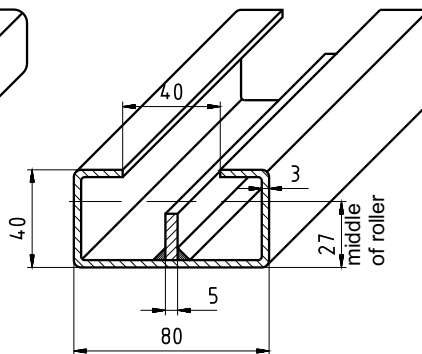

Low profile guide
weight: 4,8 kg/m

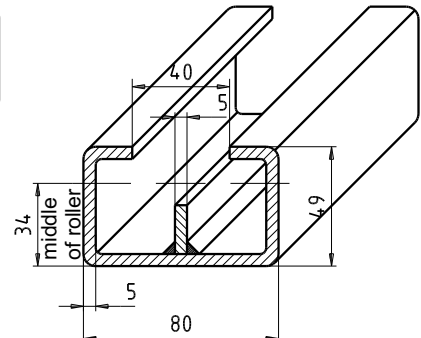

High profile guide
weight: 8,1 kg/m

D5-222e/10.04

Subject to technical changes

Push chain 0402

Type 40 PSG

3.2.4 Assembly of the standard chain link 5-0402-100.00

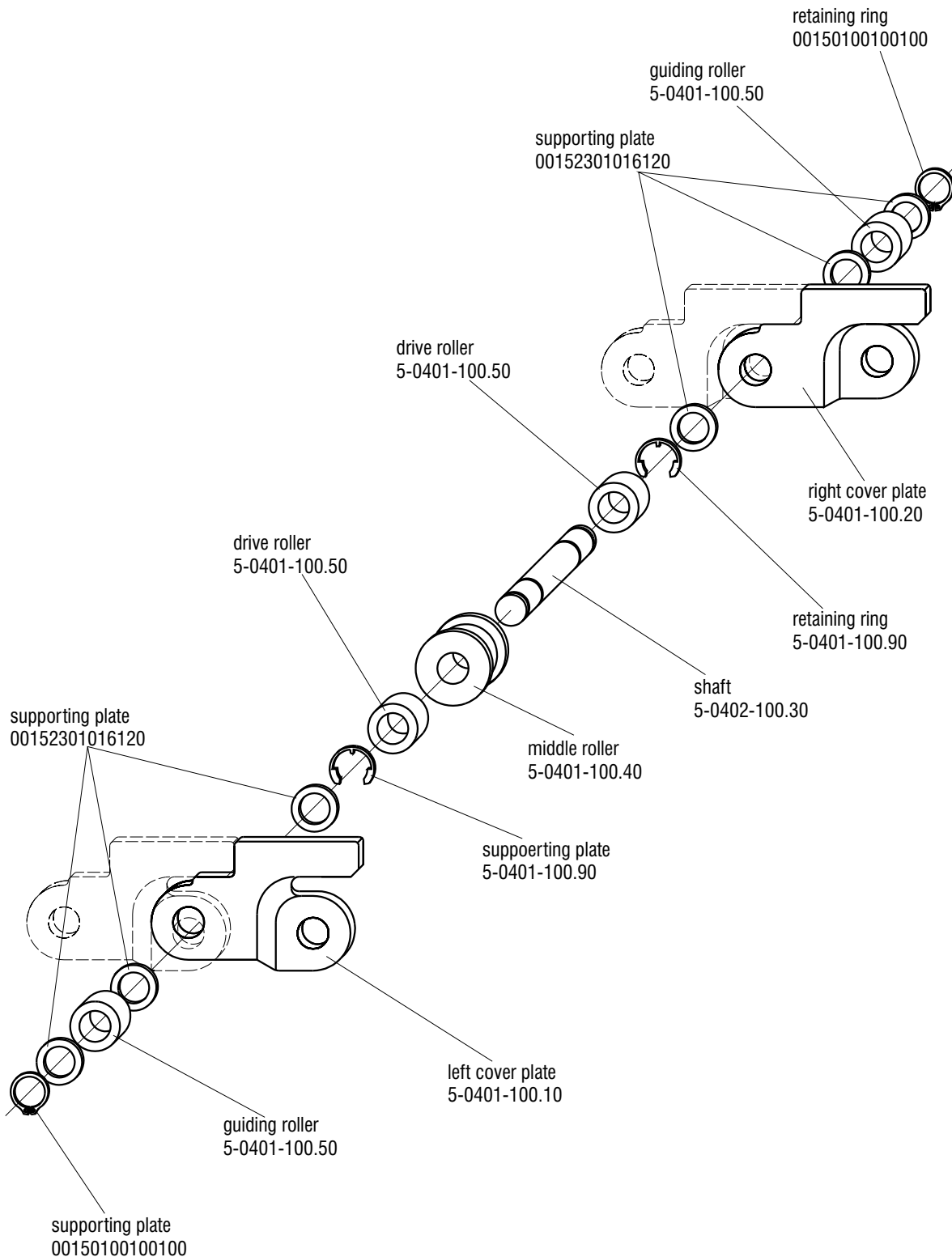

D5-223e/10.04

Subject to technical changes

Framo - Morat KG (GmbH & Co.)
Framo -Antriebstechnik

Po.-box 10 • D-79869 Eisenbach / Hochschwarzwald
Höchst 7 • D-79871 Eisenbach / Hochschwarzwald
Homepage: <http://www.framo-morat.com>

Tel. (07657) 88-0 • Fax (07657) 88-333
E-Mail: info@framo-morat.com